

The new Magma fire helmet platform concept

- Choose your personalized Magma from two unique configurations, Type A (half size shell) or Type B (three-quarter size shell) with a unified look
- Sleek design accommodates a wide variety of accessories and electronic components
- Can be easily reconfigured for new applications
- Magma offers the lowest weight and the most superior comfort in its class
- Bullard Tough ... meeting your expectations

*Helmet Type A and B according to EN443:2008

Magma新型消防头盔设计理念

- 可从同一系列的两种独特配置中选择个性化的Magma头盔：A型(半盔)和B型(全盔)
- 流线型设计，可选配多种附件和电子部件
- 能够轻松地重新配置，以适合新的用途
- Magma头盔在同类头盔中最轻最舒适
- Bullard Tough ...达到您的期望值

* Helmet A型和B型头盔符合EN443:2008标准

BETTER UNDER FIRE.



Fire Helmet Platform **magma**

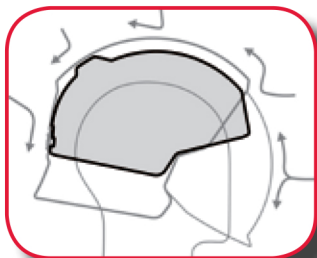

The layout of the platform, outer shell and visor encloses the inner compartment hermetically against all risks.

No comparable helmet offers a similar protection against heat, flames, sparks and fluids.

头盔基座、外壳和面屏牢牢围成一个封闭式的内腔，以提供全面的防护。

此头盔可对高温、火焰、火花和液体起到无可比拟的防护作用。

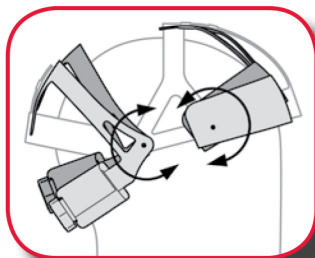

The Magma head ring is made from just three components. Clearly laid out and easy to operate.

The front and rear height of the head ring can be adjusted separately, just like the wearing height.

These functions ensure sufficient space for a perfect fit of the protective goggles and the mask.

Magma头盔仅由三部分组成。设计合理且易于操作。同佩戴高度一样，头盔的前后高度均可单独进行调整。这些特征可为使用者提供充足的空间，以便舒适地佩戴护目镜和呼吸器。

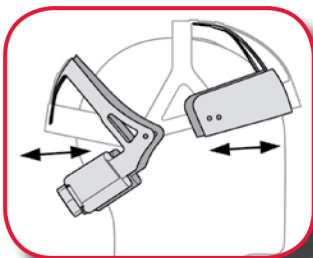

The three-dimensional visor covers the retracted front frame for a maximum upper and lateral field of view, while also covering the complete face up to the chin, leaving enough space for spectacles, protective goggles and even a respirator mask.

三维面屏完全覆盖后置的前框，可为上方和侧面提供最佳视野，并同时覆盖直至下巴的整个面部，为眼镜、护目镜甚至是呼吸器提供了足够的空间。

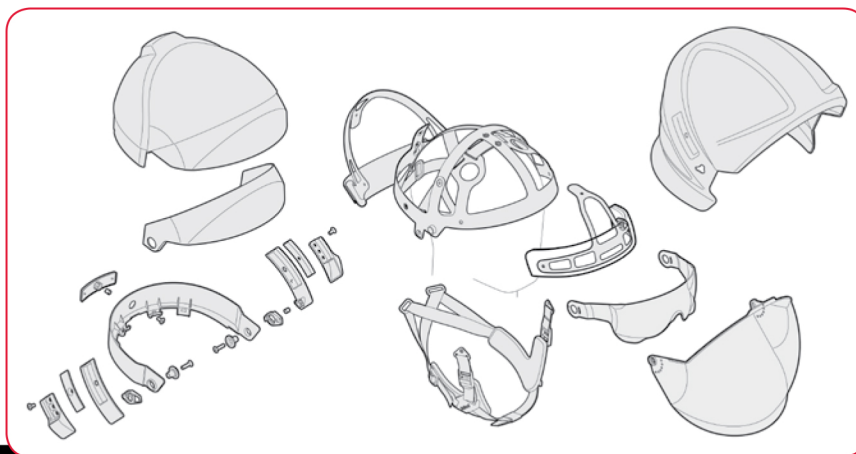

Fire Helmet Platform **magma**



The helmet is compatible with all conventional respirator masks – whether with rubber straps or adjustable two-point mask connection.

该头盔能够同所有的常规呼吸器配合使用，无论是搭配橡胶束带还是可调整的两点式呼吸器挂钩。



Radio with bone or swan microphones are located where it should and can be mounted in no time and without using tools to the designated attachment points.

为带有骨传导耳机或鹅颈式麦克风的无线通信装置设计的固定点位置合理，并可在无需使用工具的情况下将装置迅速安装到位。



By intention Bullard decided not to go with a torch model orientated system due to the fast evolvement of the LED technology and the large variety of requirements.

The newly developed torch adapter from Bullard can accommodate most types of torches.

The adapter is attached to the ergonomical position: below the eye line, for a low-reflection illumination even in intensive smoke conditions and also for a low centre of gravity.

由于LED技术的快速发展以及需求的多元化，Bullard决定不采用头灯式的系统。

Bullard全新开发的头灯适配器可与大多数型号的头灯配用。

该适配器安装在视平线下方的位置，符合人体工程学设计，即使在浓烟条件下也能提供低反射照明，而且也适用于低重心的状况。

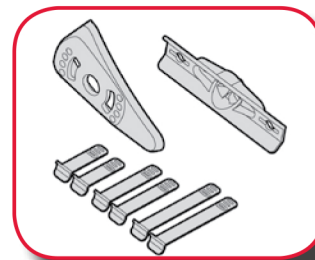

Made from Nomex with an inner liner and dovetail tuck or as "Dutch Ear Neck Protector" according to HuPF with elastic planes around the face.

由诺梅克斯面料制成，拥有内衬和燕尾褶皱缝，或根据HuPF标准利用环绕面部的弹性外层来作为“荷式护耳颈垫”。

Colors and ranking

Magma offers a huge range of colors and color combinations as well as various options for ranking by colors, logos and text on the front frame or on the reflective stripes

颜色与级别

Magma头盔具有多种颜色和色彩组合，并可按照颜色、标志以及前框或反光条带上的文字为不同的身份级别提供多种选择。



Technical Data magma

BODY STRUCTURE - 主体结构	
full insulation inside against hazards	x
全密封式设计, 可提供全面的防护	x
Weight in gramms approx. - 重量(克)	1360*
* - with no accessories - * -不包括附件	
OUTER SHELL - 外壳	
Material - 材料	3-P Composite 3-P复合 材料
Shape - 形状	
Half size - 半盔	x
- 3/4 size - 全盔	x
- Paint UV protected - 防紫外线保护层	x
Rubber edge flame resistant - 阻燃橡胶边缘	Option - 选配
Hanger/loop for attachment on truck or belt	
- 可挂在卡车或腰带上的挂钩或挂环	选配
INNER SHELL - 内壳	
Material Polyurethane - 聚氨酯材料	x
Cover inner shell - 包覆内壳	Option - 选配
Shell type - 盔壳种类	
- Full size - 全盔	x
Connection inner - 可拆卸式内外盔壳连接件	x
HEAD RING - 头套	
Sizes - 尺寸	50-65
Material - 材料	
- Flame resistant plastic - 阻燃塑胶	x
Backside offset 45° - 后移角度: 45度	x
To replace w. no tools - 无需使用工具即可进行更换	x
Head size adjustment - 头部尺寸调整	
- Ratchet - 棘轮	x
- With gloves - 佩戴手套	x
- W. helmet put on - 佩戴头盔	x
- With one hand - 单手即可	x
Front / napeband adjustable - 前端/后颈部可调	x
Adjustable height - 可调高度	x
Adjustable inclination - 可调倾斜角度	x
Horizontally adjustable - 可横向调整	x

FABRICS AND THREAD - 织物与系绳	
- Flame resistant - 阻燃	x
- Detachable - 可拆卸	x
- Single replacement - 可单独更换	x
CHIN STRAP - 下巴束带	
Number of attachment points - 固定点数量	4
Flame resistant straps + fabrics - 阻燃束带+织物	x
Points of adjustment - 调节点	4
Buckle to the side - 侧面带扣	x
VISOR - 面屏	
Slides in - 滑入式	x
Field of view to the top / to the side > 7° / 180°	x
上方/侧面视野> 7度 / 180度	x
Fits prescription glasses - 可配戴眼镜	x
Injection molded min. 2mm - 注塑成型, 最小2毫米	x
Visor length in mm - 面屏长度(毫米)	150
Antiscratch - 防刮	Option - 选配
Antifog - 防雾	Option - 选配
Goldplated version - 镀金版本	Option - 选配
Mesh visor - 网状面屏	Option - 选配
EYEPROTECTION - 眼睛保护装置	
Fits prescription glasses - 可配戴眼镜	x
Distance to face adjustable	x
距面部的距离可调	x
PROTECTIVE GOGGLE - 护目镜	
Ventilation - 通风	x
Ventilation holes covered by dust filter	x
带有滤尘器的通风孔	x
Antifog / antiscratch - 防雾/防刮	x
UV protection - 防紫外线	x
Prescription glasses avail. - 备有眼镜	x
可佩戴手套调整系带	x
Brillenbandverstellung mit Handschuhen möglich	x
镜框上没有快速释放装置	x
EAR NECK PROTECTOR - 护耳颈垫	
2 layers Nomex flannel - 双层诺梅克斯法兰绒	x
Plane attachment to shell - 颈垫固定在盔壳上	x
Extendable tuck - 可扩展缝褶	x

Dutch Ear Neck Protector - 荷式护耳颈垫		
Layer structure acc. HuPF - 护层设计符合HuPF标准		x
- Nomex outer layer - 诺梅克斯外层		x
- Insulation layer - 隔热层		x
- Moisture barrier - 防潮层		x
- Inner lining - 内衬		x
Elastic facial area - 弹性外层		x
ADAPTER - 适配器		
Torch adapter - 头灯适配器		x
Universal fit for all torches - 头灯适配器		x
- Pivotable, detachable - 枢轴式, 可拆卸		x
Radio - 无线通信装置		
- Bone and swan microphone - 骨传导耳机和鹅颈式麦克风		x
- Integrated, designated attachment points		x
- 体式的指定固定点		x
- Atex approval optional available - 备有Atex认证选项		x
REPLACEMENT PARTS - 替换部件		
Available separately - 可供选配		x
For min. 10 years - 保用期限: 最少10年		x
End user training / inspection by manufacturer		x
终端用户培训/制造商检测		x
CERTIFICATES - 证书		
Helmet type - 头盔类型		A + B / A型 + B型
EN443:2008		x
EN443 Options - EN443认证选项		all/全部
Certification accessories - 证书附件 EN443:2008		x
Visor + Eyeproetector - 面屏+护目镜 EN14458:2004		x
Protective goggle - 护目镜		
EN 166:2001, NFPA 5 min. 250°C + MIL-V-43511C		x
EN 166 :2001NFPA 5 (最低250°C) + MIL-V-43511C		x
Colors - 颜色	luminescent	荧光
Other colors on demand	white	白色
可根据要求提供其他颜色	red	红色
	black	黑色
	yellow	黄色
Date May 2010 - Stand Mai 2010	green	绿色
日期: 2010 年5月	silver	银色
	blue	蓝色